

## PRODUCT ID: 58825

### Traffic-Grade LED Blank-Out Sign

#### MODEL

STR3030RG-175/120-277VAC

#### DIMENSIONS

30" H x 30" W x 6" D (est. 40.354 lbs)

#### CLASS

Class: STO Class

Control Method: Switch (not included) or external relay.

#### CONSTRUCTION

##### Back Construction:

Cabinet: 1-piece, corrosion resistant, triple hollow, extruded aluminum frame, 6" deep.

Face Material: 1/8" impact resistant, smoke-tinted polycarbonate (5109)

Faces: Single Faced Sign

Finish: Black

Mounting Channel: None

#### ELECTRICAL

Flashing: Not Included

Input Voltage: 120-277 VAC

UL/cUL Listed: Listed for wet locations

#### MESSAGE

Illumination: Super bright direct view LEDs. Message blanks out when off.

Sign Messages: See message table below



## Product View

NOTE: Sign image may not exactly represent the finished product. For illustration purposes only.

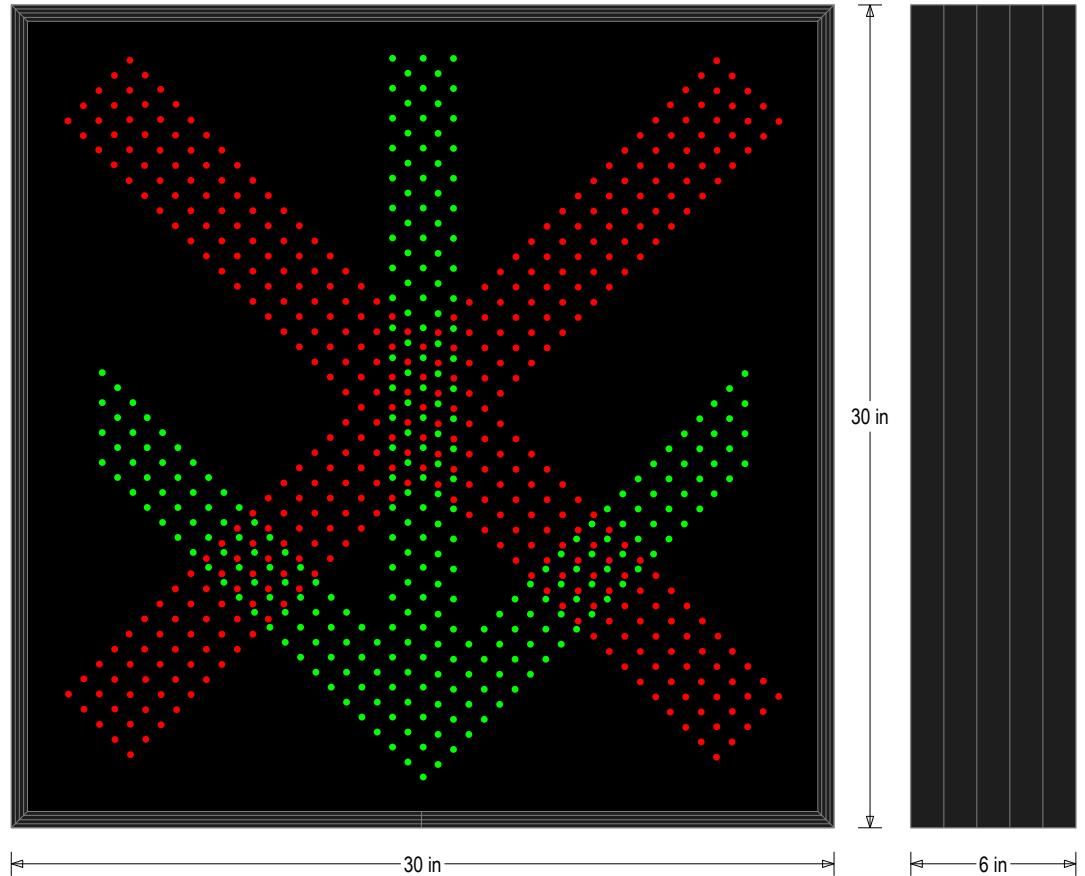

MESSAGE	LED/COLOR	HEIGHT	AMPS
---------	-----------	--------	------

X	Red Narrow Angle LED	25.25"	0.195-0.084
Down Arrow	Green Narrow Angle LED	26.25"	0.219-0.095

NOTE: Above messages are independently controlled.

### Sample Display Options

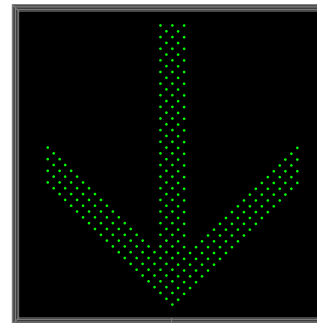
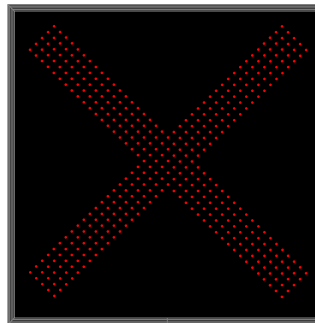

### Frame Detail

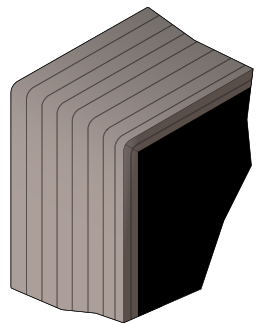

#### Signal-Tech

4985 Pittsburgh Ave.

Erie, PA 16509

Phone: (877) 547-9900

Fax: (814) 835-2300

Email: sales@signal-tech.com

Website: www.signal-tech.com

