

# PRODUCT ID: 67979

## DOT LED Blank-Out Sign

### MODEL

DOT3535RG-175/100-240VAC



### DIMENSIONS

35" H x 35" W x 6.5" D (est. 76.72 lbs)

### CLASS

Class: DOT Series

Control Method: Switch (not included) or external relay.

### CONSTRUCTION

Cabinet: Extruded aluminum cabinet with welded seams, NEMA 4X rated/IP66.

Hinged door with silicone gasket, tool-less stainless-steel latches. 6.5" Deep.

Face Material: 1/8" impact resistant, smoke-tinted polycarbonate (5109)

Faces: Single Faced Sign

Finish: Powdercoat Black

### ELECTRICAL

Input Voltage: 100-240 VAC

Photodimming: IR photocells for auto photodimming

Power Supplies: No Redundancy

UL/cUL Listed: Listed for wet locations

### MESSAGE

Illumination: Super bright direct view LEDs. Message blanks out when off.

Sign Messages: See message table below

## Product View

NOTE: Sign image may not exactly represent the finished product. For illustration purposes only.

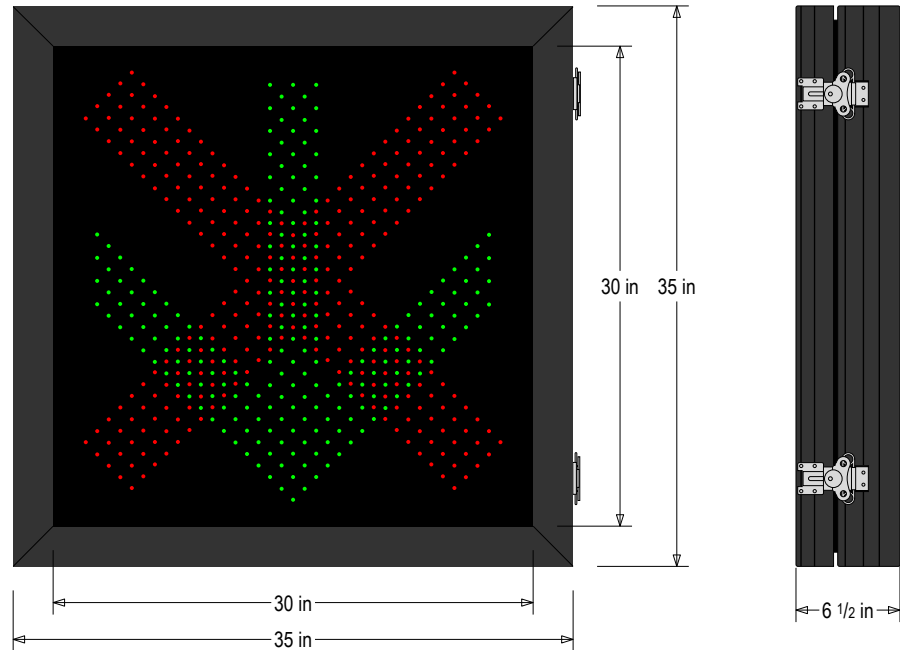

### MESSAGE

### LED/COLOR

### HEIGHT

### AMPS

X	Red Narrow Angle LED	26.0"	0.176-0.073
Down Arrow	Green Narrow Angle LED	26.0"	0.205-0.085

NOTE: Above messages are independently controlled.

### Sample Display Options

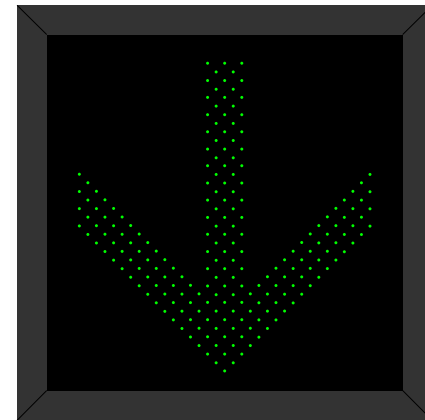
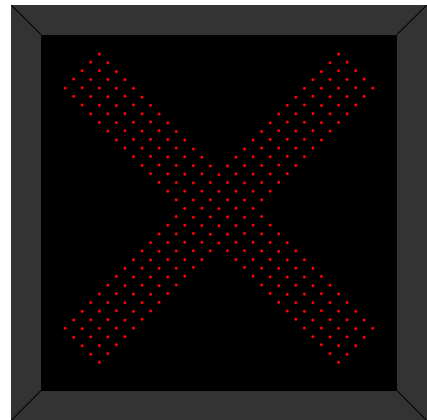

### Frame Detail

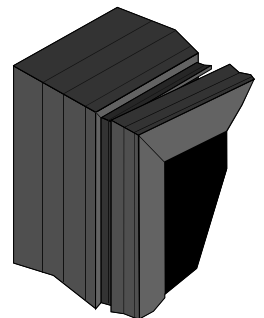

### Signal-Tech

4985 Pittsburgh Ave.

Erie, PA 16509

Phone: (877) 547-9900

Fax: (814) 835-2300

Email: sales@signal-tech.com

Website: www.signal-tech.com

